

660

Recently Remodeled

FOR LEASE

■ 660 NW Peacock Blvd

660 NW Peacock Blvd

Port Saint Lucie, FL 34986

PROPERTY OVERVIEW

Substantial manufacturing or distribution building with offices and storage loft areas. Building has 3000amp 3-phase electric. Adjacent 1.42 ac parcel can be available separately for storage yard, additional parking, and possibly dock-high transition platform.

LOCATION OVERVIEW

St Lucie West Commerce Park is within a Foreign Trade Zone area. Easy access to I-95 and The Florida Turnpike. This commerce park has in excess of 6 million square feet of industrial properties.

OFFERING SUMMARY

Building Size:	56,642 SF
Land Size:	3.13 Acres
Zoning:	Warehouse - City of Port St Lucie
Utilities:	FPL & St Lucie West Utilities

LEASE RATE

\$9.06-\$9.26 SF/YR NNN

Property Details

MANUFACTURING/DISTRIBUTION SPACE

FOR LEASE

LEASE RATE

\$9.06-\$9.26 SF/YR NNN

Location Information

Building Name	Manufacturing/Distribution Space
Street Address	660 NW Peacock Blvd
City, State, Zip	Port Saint Lucie, FL 34986
County/Township	Saint Lucie
Cross Streets	NW Mercantile Place
Side Of Street	West
Road Type	Paved
Nearest Highway	Interstate 95

Building Information

Building Size	56,642 SF
Unit 1	22,850 SF
Unit 2	11,444 SF
Unit 3	22,348 SF
Number Of Grade Level Doors	5
Year Built	1998
Overhead Door Height (Ft)	14.0
Ceilings	19 ft to 21 ft
Restrooms	9
Exterior Walls	CB Stucco
Free Standing	Yes
Number Of Buildings	1

Property Details

Property Type	Industrial
Property Subtype	Manufacturing/Warehouse/Distribution
Lot Size	3.13 Acres
APN#	3323-640-0004-000-5
Lot Frontage	346.75 FT
Lot Depth	350 FT
Corner Property	Yes
Taxes	\$82463.31

Utilities & Amenities

Zoning / Land Use Details

Zoning	Warehouse - City of Port St Lucie
Permitted Use	See Below

[Click Here For Permitted Uses](#)

Floor Plan - Units 1, 2, 3 (as built)

MANUFACTURING/DISTRIBUTION SPACE



FOR LEASE

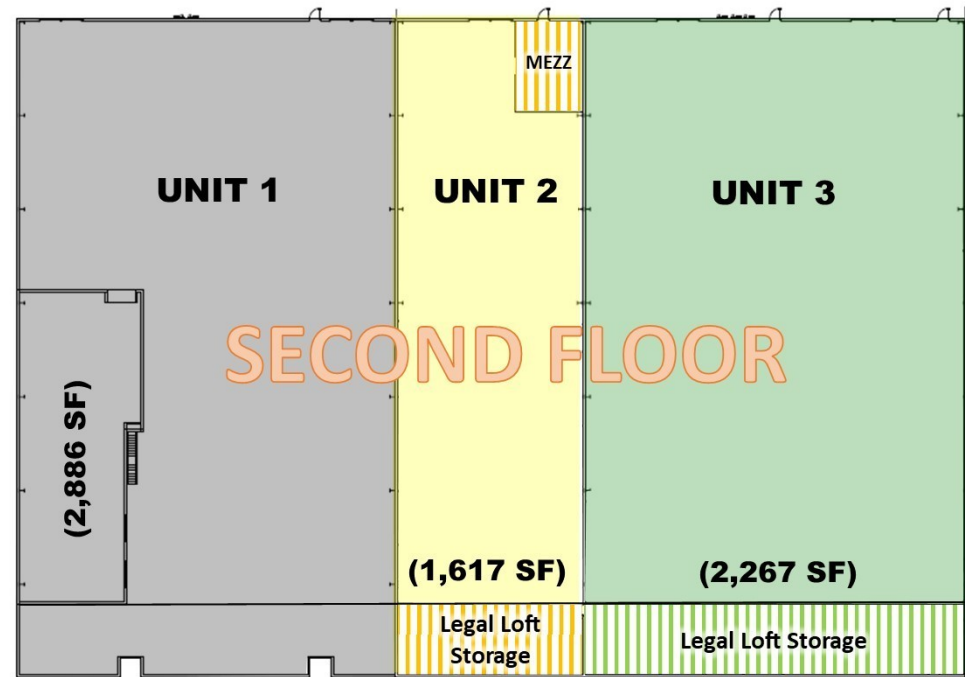
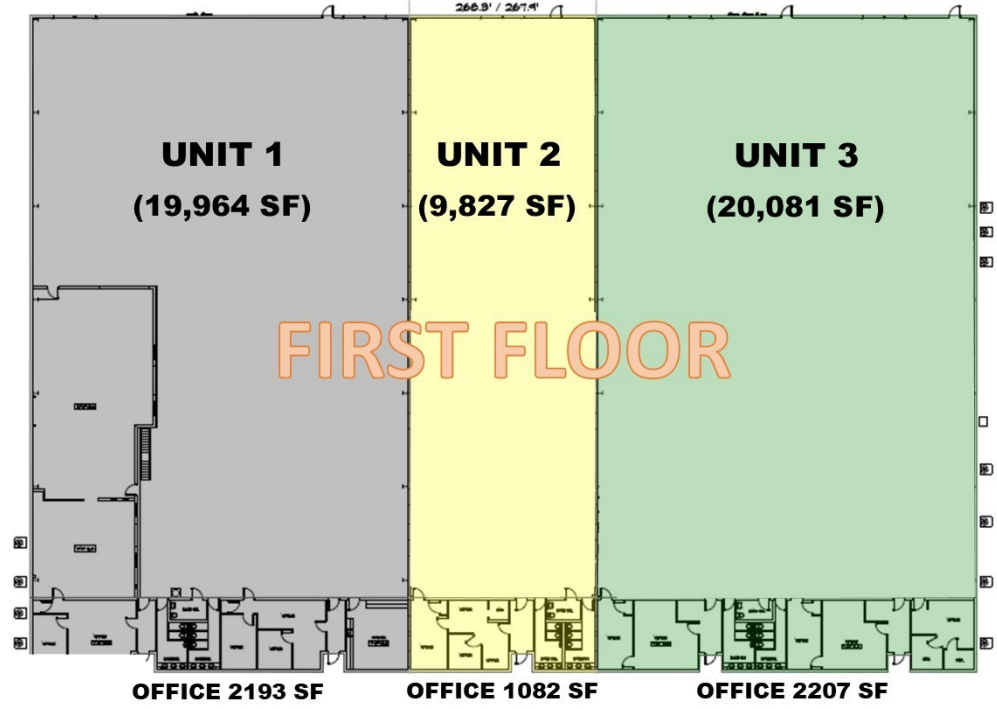

NORTH ->

Available Spaces

MANUFACTURING/DISTRIBUTION SPACE

FOR LEASE

LEASE RATE:	\$9.06-\$9.26 SF	TOTAL SPACE:	56,642 SF
LEASE TYPE:	NNN	LEASE TERM:	Min. 5 Years

Space 1 Warehouse/Distribution \$9.13 SF/yr NNN 22,850 - 56,642 SF Min. 5 Years
22,850 SF - Office/Warehouse 19,964sf with 2,886sf Mezz.

Space 2 Warehouse/Distribution \$9.06 SF/yr NNN 11,444 - 56,642 SF Min. 5 Years
11,444 SF - Office/Warehouse 9,827sf first floor with 500sf Mezz. & 1,117sf Loft.

Space 3 Warehouse/Distribution \$9.26 SF/yr NNN 22,348 - 56,642 SF Min. 5 Years
22,348 SF - Office/Warehouse 20,081sf with 2,267sf Loft.

Space 4 (1 & 2) Warehouse/Distribution \$9.13 SF/yr NNN 34,294 - 56,642 SF Min. 5 Years
34,294 SF - Office/Warehouse 29,791sf first floor with 4,503sf second floor.

Space 5 (2 & 3) Warehouse/Distribution \$9.26 SF/yr NNN 33,792 - 56,642 SF Min. 5 Years
33,792 SF - Office/Warehouse 29,908sf first floor with 3,884sf second floor.

Space 6 (1, 2 & 3) Warehouse/Distribution \$9.26 SF/yr NNN 56,642 - 56,642 SF Min 5 Years
56,642 SF - Office/Warehouse 49,872sf first floor with 6,770sf second floor.

Property Aerial

MANUFACTURING/DISTRIBUTION SPACE

FOR LEASE



Area Aerial

MANUFACTURING/DISTRIBUTION SPACE

FOR LEASE

